

Instructions for use

Size: 120*40cm

Folding: hold the desktop with both hands, lift it up horizontally, and then put it down

The table top has 5 heights

The desktop is flush with the railing
The desktop is 6cm lower than the railing
15cm lower than the railing
23cm lower than the railing
32cm lower than the railing

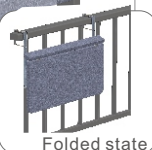

Folded state

Precautions:

1. Please evaluate whether the railings are firm (Please pay attention to glass railings).
2. All glass railings shall not be used to avoid glass breakage.

Parts list

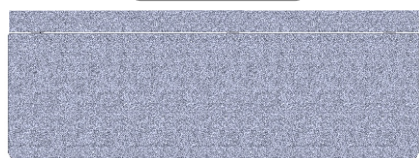

Desktop: 1 baffle: 1



Hinge: 3



Crossbar: 1 Leveling parts: 2



Velcro: 1



Wrench: 1

12 Screws: 20

35 Screws: 2



Clip: 2



Upper hook screw: 2



Lower hook screw: 2



Upright post: 2

Installation Notes

1

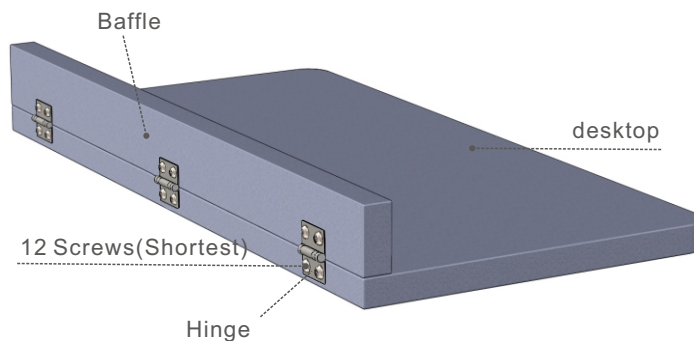

12 Screws (Shortest)

3

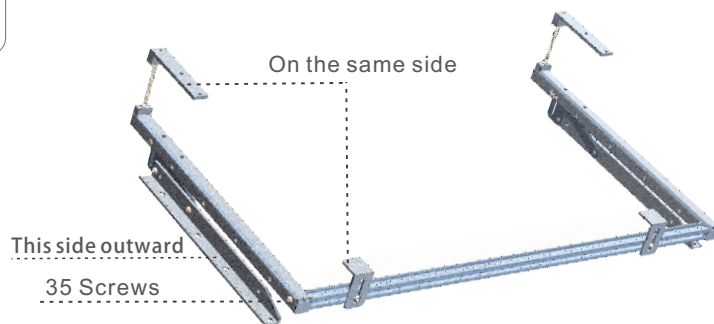

This side outward

35 Screws

5

Upper hook screw

Lower hook screw

Product inspection verification

Inspected

2

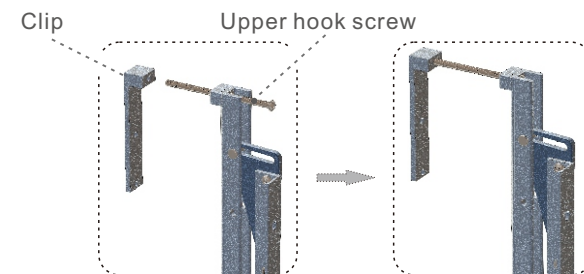

4

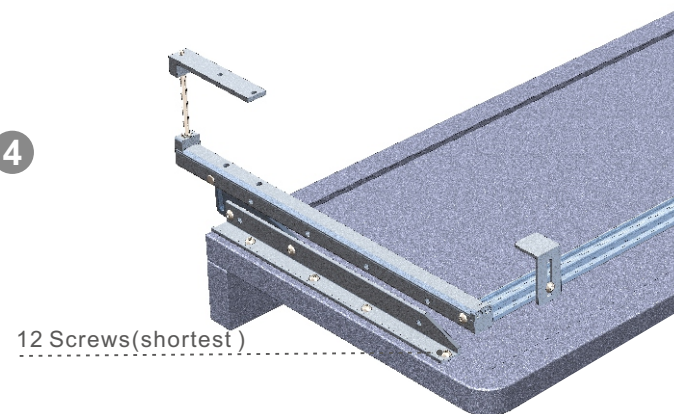

6

Wrap the Velcro around the railing to protect the railing

7

Loosen the screw (tighten it half a turn), move the leveling parts to a proper position to make the desktop level, and then tighten the screw



Leveling parts

12 Screws (shortest)

The installation method of the glass railing, pay attention that the table cannot be in contact with the glass.

copper nut (yellow)

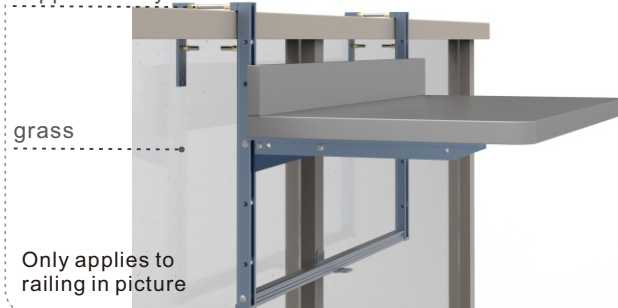

grass

Only applies to railing in picture